

GRAPHICS CARD INSTALLATION

01 Power Off the computer. Unplug the cable(s) connected to the system, and remove any existing discrete graphics card(s).

02 Remove the system case cover and locate the PCI Express x16 slot on the motherboard. Please refer to your motherboard specifications.

03 Remove the expansion slot cover(s) for the available slot(s) where the graphics card will be installed.

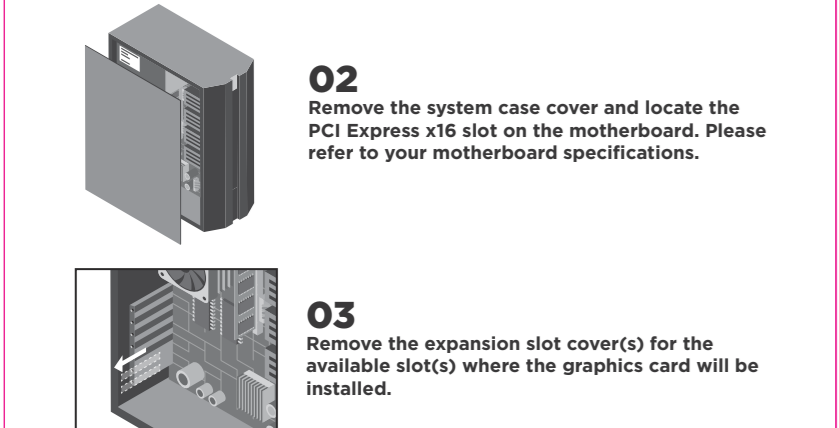

07 Replace the system case cover and reconnect the system power cable.



MORE YOU NEED TO KNOW



ZOTAC.COM



GRAPHICS CARD INSTALLATION

04/05 Insert the card firmly into the expansion slot. Secure the graphics card using the system case screw(s).

06 Connect any required PCI-e power cable(s) from the system power supply to the graphics card. Power requirements may vary by graphics card model.

NOTE: If the graphics card requires more than one 8-pin power cable, it is recommended to use separate 8-pin cables to maintain voltage stability.

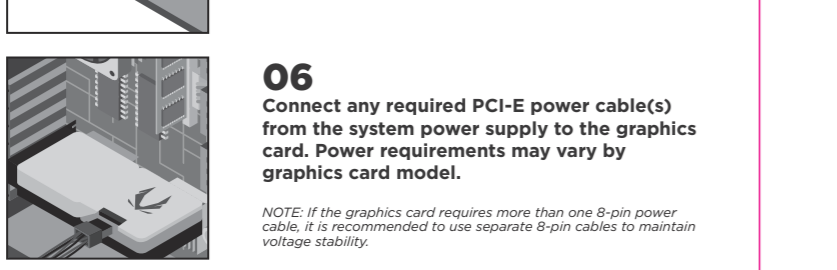

07 Replace the system case cover and reconnect the system power cable.

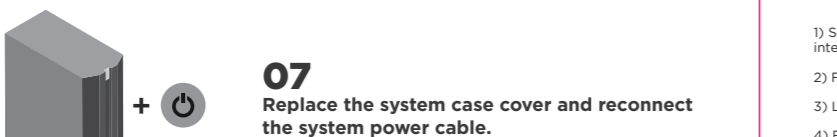

GEFORCE DRIVER INSTALLATION

PLEASE MAKE SURE TO HAVE THE LATEST AVAILABLE DRIVERS INSTALLED FOR YOUR ZOTAC GAMING GEFORCE GRAPHICS CARD FOR OPTIMAL GAMING PERFORMANCE.

NOTE: The latest GeForce Drivers are available at GEFORCE.com. An Internet connection is required to proceed.



1) Scan the above QR code to go to the NVIDIA GEFORCE™ Drivers website or enter the URL into your system's Internet browser - <https://www.geforce.com/drivers>

2) Follow the onscreen menu to download the GeForce drivers for your graphics card model and OS.

3) Locate the downloaded file on your system and double click it to begin the installation process.

4) Follow the on-screen instructions to complete the installation and restart the system once done.

快速安裝指南

安裝 GeForce 驅動程序
請前往 GEFORCE.com 下載、安裝最新驅動程序
請前往 GEFORCE.com 網站下載、安裝最新驅動程序

NOTE: The latest GeForce Drivers are available at GEFORCE.com. An Internet connection is required to proceed.

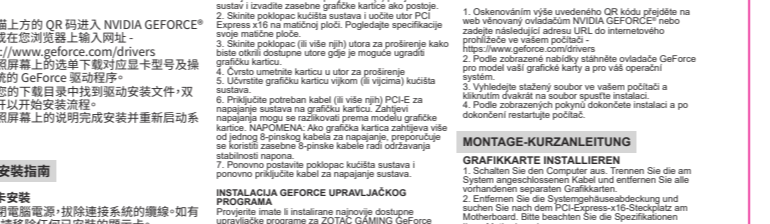

1) 掃描上方的 QR 碼進入 NVIDIA GEFORCE™ 兩版或您系統對應的網頁，或將網址輸入到系統網路瀏覽器 - <https://www.geforce.com/drivers>

2) 依照螢幕上的指示，下載您的顯示卡型號及操作系統的 GeForce 驅動程序。

3) 定位下載的檔案，雙擊檔案以開始安裝程序。

4) 依照螢幕上的指示，完成安裝並重新啟動系統。

QUÉ ESTABLECER RÁPIDAMENTE

Instalación de los controladores GeForce
Visite www.geforce.com para descargar los controladores de su tarjeta gráfica GeForce. Se requiere conexión a Internet para proceder.

NOTE: The latest GeForce Drivers are available at GEFORCE.com. An Internet connection is required to proceed.

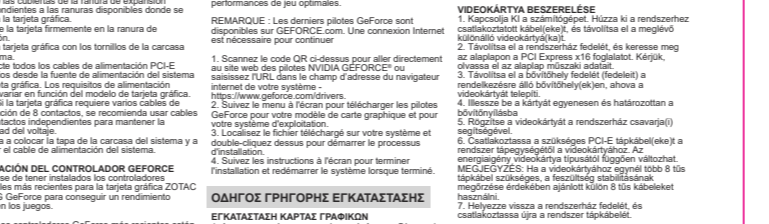

1) Escanee el código QR para ir a la página de descargas de controladores GeForce en el sitio web de NVIDIA GEFORCE™ Drivers o introduzca la URL en el navegador de Internet de su sistema.

2) Siga el menú de pantalla para descargar los controladores GeForce para su tarjeta gráfica GeForce y su sistema operativo.

3) Localice el archivo descargado en su sistema y haga clic en él para comenzar el proceso de instalación.

4) Siga las instrucciones de pantalla para completar la instalación y reiniciar el sistema una vez hecho.

INSTALAZIONE RAPIDA

Instalazione dei driver GeForce
Visitate il sito www.geforce.com per scaricare i driver della vostra scheda grafica GeForce. È necessaria una connessione Internet per procedere.

NOTE: The latest GeForce Drivers are available at GEFORCE.com. An Internet connection is required to proceed.

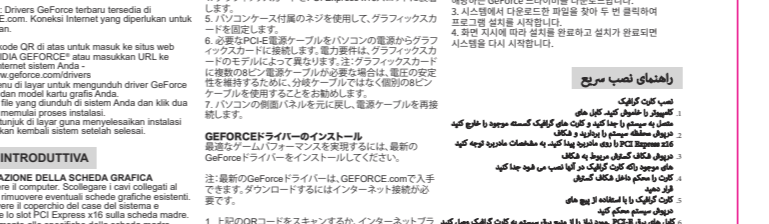

1) Scansionare il codice QR per accedere al sito Web di download dei driver GeForce sul sito NVIDIA GEFORCE™ Drivers o inserire l'URL nel browser Internet del sistema.

2) Seguire il menu di schermo per scaricare i driver GeForce per la propria scheda grafica GeForce e il sistema operativo.

3) Individuare il file scaricato nel sistema e cliccare su di esso per avviare il processo di installazione.

4) Seguire le istruzioni di schermo per completare l'installazione e riavviare il sistema una volta fatto.

INSTALAZIONE RAPIDA

Instalación de los controladores GeForce
Visite www.geforce.com para descargar los controladores de su tarjeta gráfica GeForce. Se requiere conexión a Internet para proceder.

NOTE: The latest GeForce Drivers are available at GEFORCE.com. An Internet connection is required to proceed.

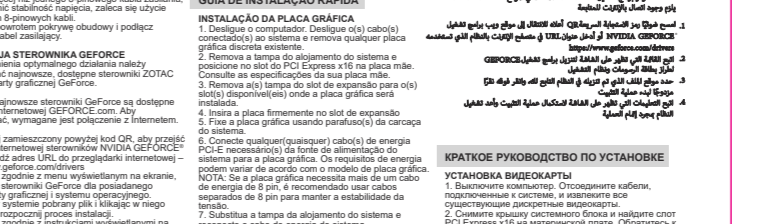

1) Escanee o toque el código QR para ir a la página de descargas de controladores GeForce en el sitio web de NVIDIA GEFORCE™ Drivers o introduzca la URL en el navegador de Internet de su sistema.

2) Siga el menú de pantalla para descargar los controladores GeForce para su tarjeta gráfica GeForce y su sistema operativo.

3) Localice el archivo descargado en su sistema y haga clic en él para comenzar el proceso de instalación.

4) Siga las instrucciones de pantalla para completar la instalación y reiniciar el sistema una vez hecho.

INSTALAZIONE RAPIDA

Instalazione dei driver GeForce
Visitate il sito www.geforce.com per scaricare i driver della vostra scheda grafica GeForce. È necessaria una connessione Internet per procedere.

NOTE: The latest GeForce Drivers are available at GEFORCE.com. An Internet connection is required to proceed.

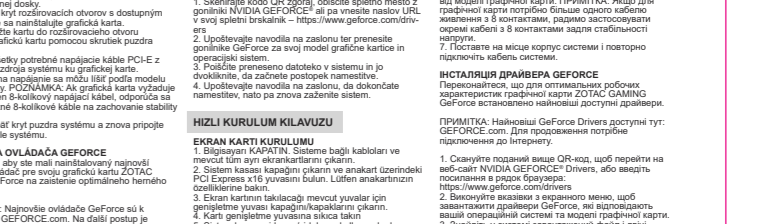

1) Scansionare il codice QR per accedere al sito Web di download dei driver GeForce sul sito NVIDIA GEFORCE™ Drivers o inserire l'URL nel browser Internet del sistema.

2) Seguire il menu di schermo per scaricare i driver GeForce per la propria scheda grafica GeForce e il sistema operativo.

3) Individuare il file scaricato nel sistema e cliccare su di esso per avviare il processo di installazione.

4) Seguire le istruzioni di schermo per completare l'installazione e riavviare il sistema una volta fatto.

CONNECT A MONITOR

CONNECTING A DISPLAY TO THE GRAPHICS CARD

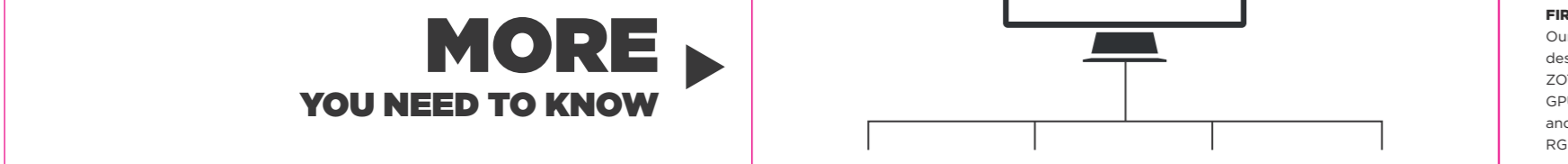

291-CN001-3027F

ZOTAC.COM



USEFUL LINKS

PRODUCT REGISTRATION
Register your new product on ZOTAC.COM to get FREE extended product warranty where applicable.

FIRESTORM UTILITY
Our advanced fine-tuning software utilizes a simplified design to allow easy and immersive control of your ZOTAC and ZOTAC GAMING graphics cards. Monitor GPU performance, adjust the speed of clock, memory and fan, customize fan profile as well as SPECTRA RGB lighting, and do much more.

SUPPORT/CONTACT US
Need any help with your ZOTAC products? Please go to our Support page to find the answers, or simply contact us so we can provide the needed support.

WARRANTY
ZOTAC Technology Ltd. reserves the right to void the warranty if:

Under no circumstances is ZOTAC Technology Ltd. held liable for any lost wages or revenues incurred due to defective or damaged products. ZOTAC Technology Ltd. does not provide any additional warranty for its products except as stated in the warranty terms, whether by implication or merchant intention.

WARRANTY

ZOTAC Technology Limited stands by the quality of its products with a limited warranty. The ZOTAC warranty applies to all products except as stated in the warranty terms, whether by implication or merchant intention.

EXTENDED WARRANTY
ZOTAC products come with a standard warranty period. In addition, customers will be entitled to extended product warranty through an online product registration process within a limited time of new product purchase where applicable. ZOTAC reserves the right to change the terms and conditions without advance notice.

NOTE!
All warranty conditions and terms are subject to change without prior notice. For current warranty details, please check our online policies at ZOTAC.COM

Under no circumstances is ZOTAC Technology Ltd. held liable for any lost wages or revenues incurred due to defective or damaged products. ZOTAC Technology Ltd. does not provide any additional warranty for its products except as stated in the warranty terms, whether by implication or merchant intention.

SAFETY

1) Before playing video games
Make sure that the room is well illuminated and lighting is adjusted to the brightness of the monitor. Keep a static distance from the display monitor.

2) Static electricity precautions
Do not take the graphics card out from the original static electricity protection package until you are ready to install it. Before installing, wear a grounded wrist strap if possible, or discharge static electricity by touching the bare metal surface of the system chassis. Carefully hold the graphics card by its rear bracket, and avoid touching the "gold finger" PCB edge connector unless it is necessary.

3) Turn off system power before installing the graphics card
Turn off the AC main power to the system, by the AC main power switch or by detaching the AC power cord. Damage to the graphics card or the system components, or injury to you may result if power is turned on during the installation. Please directly a qualified technician if necessary. The manufacturer assumes no liability for any damage, caused directly or indirectly, by improper installation by unauthorized service personnel.

4) Electrical safety
Each graphics card requires a power supply that meets or exceeds a minimum wattage and/or PCIe connectors. High-end graphics cards may feature higher power consumption. Make sure that separate power cables are used on high power draw graphics cards and your power supply is set to the correct voltage for your region.

5) Operation Safety
Do not touch the card or block the fans from running while in operation to reduce the risk of injury. Parts such as the backplate and heatsink can be hot to the touch under heavy load. Allow at least 5 minutes to pass after powering down to make sure all components have cooled down for safe handling.

6) Trigger Warning: Photosensitive epilepsy
Extremely pronounced lighting effects such as fast image changes, repetitions of simple geometric shapes, flashes of light may induce epileptic fits or blackouts in some persons. Even persons with no previous known tendency to epilepsy may be in danger if you or member of your family has been diagnosed as prone to epilepsy, please consult your physician before playing the video game. Parents should monitor their children carefully when they play video games. Stop playing immediately if the following symptoms are detected: nausea, vision disturbance, muscle tension or cramps, orientation problems, involuntary movements or brief loss of consciousness.

COPYRIGHT AND DISCLAIMER

Copyright © ZOTAC Technology Ltd. All Rights Reserved
No part of this document, including the products and software described in it, may be reproduced, transmitted, transcribed, stored in a retrieval system, or translated into any language in any form by any means, without the express written permission of ZOTAC Technology Limited.

DISCLAIMER
All illustrations used in this document is for reference only.
ZOTAC Technology Limited provides this document "as is" without warranty of any kind, either express or implied, including but not limited to the implied warranties or conditions of merchantability or fitness for a particular purpose. In no event shall ZOTAC Technology Limited be liable for any indirect, special, incidental, or consequential damages (including damages for loss of profits, loss of business, loss of use or data, interruption of business and the like), even if PC Partner has been advised of the possibility of such damages arising from any defect or error in this manual or product.

TRADEMARKS
Products and corporate names appearing in this manual may or may not be registered trademarks or copyrights of their respective companies, and are used only for identification or explanation and to the owner's benefit, without intent to infringe.
NVIDIA is a trademark of NVIDIA Corporation. Windows is a trademark of Microsoft Corp.

HDMI
The Adopted Trademarks HDMI, HDMI High-Definition Multimedia Interface, HDMI Trade Dress and the HDMI Logos are trademarks or registered trademarks of HDMI Licensing Administrator, Inc. in the United States and other countries.

MACROVISION

This product incorporates copyright protection technology that is protected by method claims of certain U.S. patents and other intellectual property rights owned by Macrovision Corporation and other rights owners. Use of this copyright protection technology must be authorized by Macrovision Corporation, and is intended for home and other limited viewing use only unless otherwise authorized by Macrovision Corporation. Reverse engineering or disassembly is prohibited.

NVIDIA is a trademark of NVIDIA Corporation. Windows is a trademark of Microsoft Corp.

HDMI
The Adopted Trademarks HDMI, HDMI High-Definition Multimedia Interface, HDMI Trade Dress and the HDMI Logos are trademarks or registered trademarks of HDMI Licensing Administrator, Inc. in the United States and other countries.

Under no circumstances is ZOTAC Technology Ltd. held liable for any lost wages or revenues incurred due to defective or damaged products. ZOTAC Technology Ltd. does not provide any additional warranty for its products except as stated in the warranty terms, whether by implication or merchant intention.

ZOTAC

Under no circumstances is ZOTAC Technology Ltd. held liable for any lost wages or revenues incurred due to defective or damaged products. ZOTAC Technology Ltd. does not provide any additional warranty for its products except as stated in the warranty terms, whether by implication or merchant intention.

Under no circumstances is ZOTAC Technology Ltd. held liable for any lost wages or revenues incurred due to defective or damaged products. ZOTAC Technology Ltd. does not provide any additional warranty for its products except as stated in the warranty terms, whether by implication or merchant intention.

Under no circumstances is ZOTAC Technology Ltd. held liable for any lost wages or revenues incurred due to defective or damaged products. ZOTAC Technology Ltd. does not provide any additional warranty for its products except as stated in the warranty terms, whether by implication or merchant intention.

Under no circumstances is ZOTAC Technology Ltd. held liable for any lost wages or revenues incurred due to defective or damaged products. ZOTAC Technology Ltd. does not provide any additional warranty for its products except as stated in the warranty terms, whether by implication or merchant intention.

Under no circumstances is ZOTAC Technology Ltd. held liable for any lost wages or revenues incurred due to defective or damaged products. ZOTAC Technology Ltd. does not provide any additional warranty for its products except as stated in the warranty terms, whether by implication or merchant intention.

Under no circumstances is ZOTAC Technology Ltd. held liable for any lost wages or revenues incurred due to defective or damaged products. ZOTAC Technology Ltd. does not provide any additional warranty for its products except as stated in the warranty terms, whether by implication or merchant intention.