



# ROG CETRA TRUE WIRELESS

Quick Start Guide (English)  
 快速使用指南 (繁體中文)  
 快速使用指南 (簡體中文)  
 クイックスタートガイド (日本語)  
 간단사용설명서 (한국어)  
 Guide de démarrage rapide (Français)  
 Schnellstartanleitung (Deutsch)  
 Guida rapida (Italiano)  
 Guia de consulta rápida (Português)  
 Краткое руководство (Русский)  
 Guía de inicio rápido (Español)  
 Beknopte handleiding (Nederlands)

Rychlý průvodce (Čeština)  
 Stručný návod na používanie (Slovenčina)  
 Стиле керівництво для початку експлуатації (Українська)  
 Hızlı Başlangıç Kilavuzu (Türkçe)  
 Przewodnik szybkiego startu (Polski)  
 Ghid de pornire rapidă (Romanian)  
 Gyors üzembe helyezési útmutató (Magyar)  
 Snabbstartshandbok (Svenska)  
 Pikaopas (Suomi)  
 Hurtigstartveiledning (Norsk)  
 دليل التشغيل السريع (العربية)  
 מדרוך להתחלה מהירה (HB)



## Package contents



## Product Features

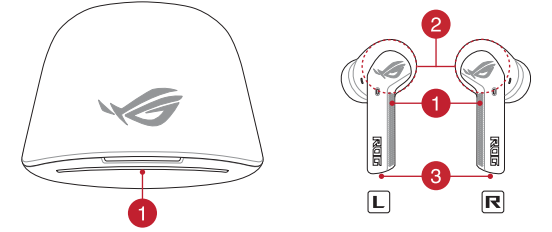

- Indicator / 指示燈 (繁體中文) / 指示灯 (簡體中文) / Témoin lumineux (FR) / Anzeige (DE) / Indicatore (IT) / Индикатор (RU) / インジケーター (JP) / Indicador (ES) / Göstergesi (TR) / Indikátor (CS) / Indicator (NL) / Indicador (PT-BR) / 표시등 (KO) / Индикатор (UA) / Indikator (SV) / Indikator (NO) / Merkkivalo (FI) / Wskaźnik (PL) / Jelzőfény (HU) / Indikátor (SK) / Indicator (RO) / مؤشر (AR) / مؤذن (HB)
- Touch panel / 觸控區 (繁體中文) / 触控区 (簡體中文) / タッチパネル (JP) / 터치 패널 (KO) / Ecran tactile (FR) / Touchpanel (DE) / Pannello a sfioramento (IT) / Painel de toque (PT-BR) / Сенсорная панель (RU) / Panel táctil (ES) / Aanraakscherm (NL) / Dokunma alany (TR) / Сенсорна панель (UA) / Panel dotykowy (PL) / Dotykowym panelu (CS) / Ecran tactil (RO) / Érintőpanel (HU) / Touchskärm (SV) / Kosketuspaneeli (FI) / Beröringskjermet (NO) / لوحة اللمس (AR) / Dotykový panel (SK) / מסך המגע (HB)
- Microphone / 麥克風 (繁體中文) / 麦克风 (簡體中文) / マイク (JP) / 마이크 (KO) / Microphone (FR) / Mikrofon (DE) / Microfono (IT) / Microfone (PT-BR) / Микрофон (RU) / Mikrofoon (ES) / Mikrofon (NL) / Mikrofon (CS) / Mikrofon (SK) / Mikrofon (TR) / Mikrofon (UA) / Mikrofon (SV) / Mikrofon (NO) / Mikrofon (FI) / Mikrofon (PL) / Mikrofon (HU) / Mikrofon (RO) / ميكروفون (AR) / מיקרופון (HB)

## Getting Started

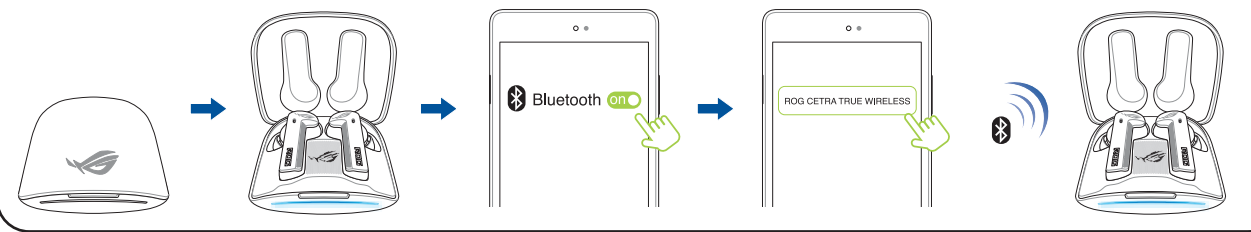

## Charging the earphones

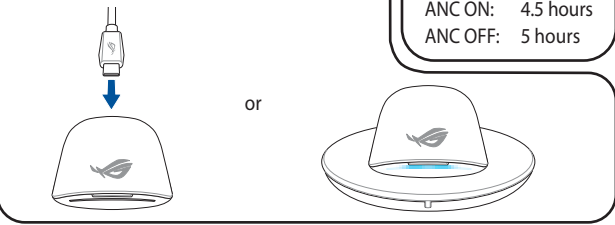

## Play time

ANC ON: 4.5 hours  
 ANC OFF: 5 hours

## Armoury Crate app



## Battery Indication (charging)

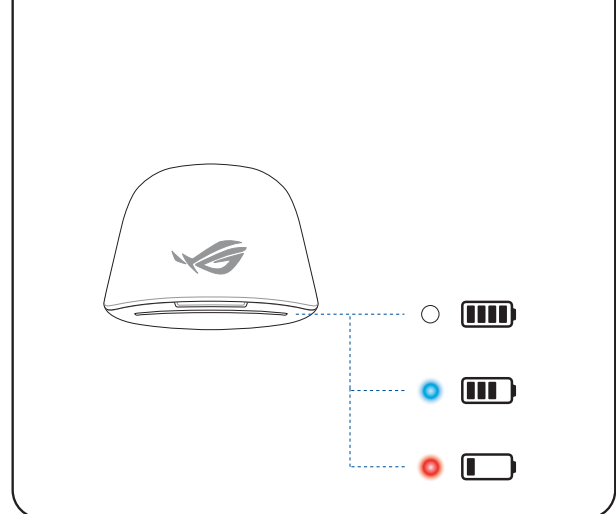

## Battery Indication (not charging)

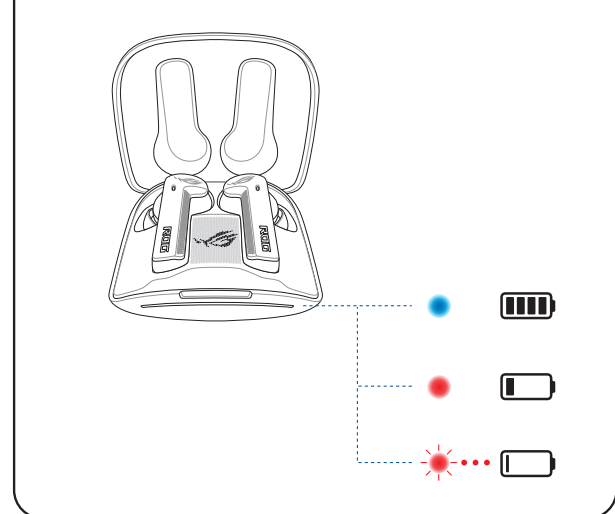

## Gestures

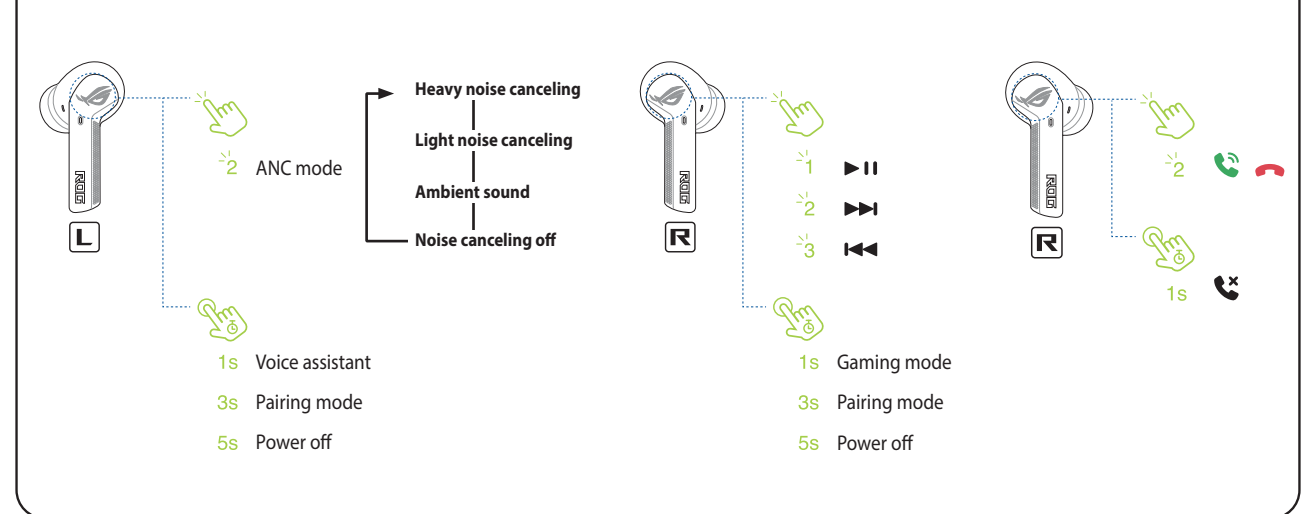

## Safety Guidelines

**About the accessories**  
 Accessories that came with this product have been designed and verified for the use in connection with this product. Never use accessories for other products to prevent the risk of electric shock or fire.

付属品は本製品専用です。本製品を使用の際には、必ず製品/パッケージに付属のものをお使いください。また、付属品は絶対他の製品には使用しないでください。製品破損もしくは、火災や感電の原因となる場合があります。

**ANC mode**

- (EN) DO NOT use your headphones or toggle ON ANC mode in situations or environments that requires your full attention or requires you to be aware of surrounding sounds, such as when driving or in a construction site, failure to do so may pose as a danger to yourself or others.
- (ZH) 在需要全神貫注或需要注意周圍聲音的情況或環境中（例如在駕駛途中或在建築工地時），請勿使用耳機或打開 ANC 模式，否則可能會對您或他人構成危險。
- (ZHSC) 在需要全神貫注或需要注意周圍聲音的情況或環境中（例如在駕駛途中或在建築工地時），請勿使用耳機或打開 ANC 模式，否則可能會對您或他人構成危險。
- (JP) 自転車、オートバイ、または自動車などを運転中には絶対に使用しないでください。運転中に使用すると、交通事故の原因になります。運転中以外でも、路切や駅のホーム、車道、工事現場など、周囲の音が聞こえないと危険な場所では使用しないでください。
- (KO) 차량을 운전하거나 건설 현장에서와 같이 주의를 기울여야하거나 주변 소리를 인식해야 하는 상황이나 환경에서는 ANC 헤드폰을 사용하지거나 켜지 마십시오. 그렇게 하지 않으면 자신이나 다른 사람이 위험 할 수 있습니다.
- (FR) Ne portez pas votre casque ou n'activez pas le mode ANC lorsque vous vous trouvez dans des situations ou des environnements qui nécessitent de porter une attention particulière au sons environnants, notamment lors de la conduite d'un véhicule ou sur un chantier de construction. Le non-respect de cette consigne peut vous mettre en danger et mettre en danger les personnes présentes.

- (DE) Verwenden Sie NICHT Ihren Kopfhörer und schalten Sie nicht in den ANC-Modus um in Situationen oder Umgebungen, die Ihre volle Aufmerksamkeit erfordern oder in denen Sie Ihre Umgebungsgeräusche wahrnehmen müssen, z. B. beim Fahren oder auf einer Baustelle. Nichtbeachtung kann eine Gefahr für Sie selbst oder andere darstellen.
- (IT) NON utilizzare le cuffie o attivare la modalità ANC in situazioni o ambienti che richiedono la totale attenzione dell'utente o che richiedono di essere consapevoli dei suoni circostanti, come durante la guida o in un cantiere. La mancata osservanza di questa precauzione può rappresentare un pericolo per se stessi o gli altri.
- (PT-BR) NÃO use seus fones de ouvido ou alterne para o modo ANC em situações ou ambientes que exijam sua total atenção ou exijam que você esteja ciente dos sons ao redor, como ao dirigir ou em um canteiro de obras. Não seguir estas instruções pode representar um perigo para você ou para os outros.
- (RU) DO NOT use your headphones or toggle ON ANC mode in situations or environments that requires your full attention or requires you to be aware of surrounding sounds, such as when driving or in a construction site, failure to do so may pose as a danger to yourself or others.
- (ES) NO use los auriculares ni active el modo ANC en situaciones o entornos que requieran su atención total o que necesite ser consciente de los sonidos de alrededor, como cuando conduce o en un sitio de obras. El no seguir esta recomendación puede suponer un peligro para usted u otras personas.
- (DU) Gebruik geen hoofdtelefoon of zet de ANC-modus NIET AAN in situaties of omgevingen die uw volle aandacht vereisen of die vereisen dat u zich bewust bent van de omgevende geluiden, zoals wanneer u een voertuig bestuurt of als u zich op een bouwterrein bevindt. Als u dit niet naleeft, kunt u een gevaar betekenen voor uzelf of anderen.
- (TR) Tüm dikkatinizi vermeniz gerektiren veya çevredeki seslerden haberdar olmanız gereken (örneğin araba kullanırken veya bir santiyede) kulaklık KULLANMAYIN veya ANC modunu etkinleştirmez. Bu öneriyi uymaması, size veya başkaları için tehlike oluşturabilir.
- (UA) НЕ ЗАСТОСОВУЙТЕ гарнітуру і НЕ ВМИКАЙТЕ режим ANC в ситуаціях або умовах, які вимагають повної уваги, або коли необхідно чути всі звуки довкола, як-от під час водіння або на будівництві. Не виконуючи ці правила, ви наражаєте на небезпеку себе та інших.
- (PL) NIE WOLNO korzystać ze słuchawek ani włączać trybu ANC w sytuacjach i miejscach wymagających pełnej uwagi użytkownika lub słyszenia dźwięków otoczenia, np. podczas prowadzenia pojazdu lub na placu budowy. Niezastosowanie się do tego może stanowić zagrożenie dla użytkownika lub innych osób.
- (CS) NEPOUŽÍVEJTE sluchátka ani NEZAPÍNEJTE režim ANC v situaci nebo prostředí, ve kterém je vyžadována vaše plná pozornost, nebo když musíte sledovat okolní zvuky, například při řízení vozidla nebo na staveništi. Zanedbáním těchto pokynů se můžete vy nebo další osoby vystavit nebezpečí.
- (RO) NU folosiți căștile și nu activați modul ANC în situații sau medii care necesită atenția dvs. deplină sau care vă solicită să fiți conștienți de sunetele din jur, cum ar fi când conduceți sau când vă aflați pe un șantier, deoarece vă puteți pune în pericol pe dvs. sau pe cei din jur.
- (HU) NE használja a fejhallgatókat, vagy kapcsolja BE az ANC módot olyan helyzetben vagy környezetben, amely teljes figyelmet igényel, vagy ahol szükséges a környező hangokra való figyelés, úgy mint vezetés közben vagy építkezésen, ennek elmulasztása veszélyt jelenthet az Ön és mások számára.
- (SV) Använd INTE hörlurar eller sätt PÅ ANC-läget i situationer eller miljöer som kräver din fullständiga uppmärksamhet eller kräver att du är medveten om omgivande ljud, som när du kör eller är på en byggarbetsplats. Underlåtenhet att följa rekommendationen kan utgöra en fara för dig själv och andra.
- (FI) ÄLÄ käytä kuulokkeita tai vaihda ON ANC-tilaan tilanteissa tai ympäristöissä, jotka vaativat täyttä huomiota tai vaativat sinun olevan tietoinen ympäristön äänistä, kuten autolla ajassa tai rakennustyömaalla, tämän laiminlyönti voi muodostaa vaaran itsellesi tai muille.
- (NO) IKKE bruk hodetelefonene eller slå på støykanselleringer i situasjoner eller miljøer som krever full oppmerksomhet eller at du er klar over lyder i omgivelsene, for eksempel når du kjører eller er på en byggeplass. Ellers kan det utgjøre en fare for deg selv eller andre.
- (AR) لا تستخدم سماعات الرأس خاصتك أو تحول إلى وضع ON ANC في الموقف أو البيئة التي تتطلب انتباهك التام أو تتطلب منك الوعي بالأصوات المحيطة مثل: أثناء القيادة أو في موقع البناء والإخفاق في القيام بذلك قد يعرضك أو يعرض الآخرين للخطر.
- (SK) Slúchadlá NEPOUŽÍVAJTE ani nezapínajte režim ANC v situáciách alebo prostrediach, ktoré si vyžadujú vašu plnú pozornosť alebo aby ste vnímali okolité zvuky, ako napríklad pri jazde s vozidlom alebo na stavenisku. Ak tak neurobite, môžete ohroziť seba alebo iných.
- (HB) לעשי שמעיה, כגון בנהיגה או באתר בנייה, או יצית להנחה זו עולו לתות סנה לך ולאחרים. אין להשתמש באוזניות או להפנית מצב ANC במצבים או בסביבה שמחייבים תשומת לב מלאה או כאשר עליך להיות מודע.



## Notices

### Federal Communications Commission Statement

This device complies with Part 15 of the FCC Rules. Operation is subject to the following two conditions:

- This device may not cause harmful interference.
- This device must accept any interference received including interference that may cause undesired operation.

This equipment has been tested and found to comply with the limits for a Class B digital device, pursuant to Part 15 of the FCC Rules. These limits are designed to provide reasonable protection against harmful interference in a residential installation. This equipment generates, uses and can radiate radio frequency energy and, if not installed and used in accordance with manufacturer's instructions, may cause harmful interference to radio communications. However, there is no guarantee that interference will not occur in a particular installation. If this equipment does cause harmful interference to radio or television reception, which can be determined by turning the equipment off and on, the user is encouraged to try to correct the interference by one or more of the following measures:

- Reorient or relocate the receiving antenna.
- Increase the separation between the equipment and receiver.
- Connect the equipment to an outlet on a circuit different from that to which the receiver is connected.
- Consult the dealer or an experienced radio/TV technician for help.

**CAUTION!** The use of shielded cables for connection of the monitor to the graphics card is required to assure compliance with FCC regulations. Changes or modifications to this unit not expressly approved by the party responsible for compliance could void the user's authority to operate this equipment.

### Limitation of Liability

Circumstances may arise where because of a default on ASUS' part or other liability, you are entitled to recover damages from ASUS. In each such instance, regardless of the basis on which you are entitled to claim damages from ASUS, ASUS is liable for no more than damages for bodily injury (including death) and damage to real property and tangible personal property; or any other actual and direct damages resulted from omission or failure of performing legal duties under this Warranty Statement, up to the listed contract price of each product.

ASUS will only be responsible for or indemnify you for loss, damages or claims based in contract, tort or infringement under this Warranty Statement.

This limit also applies to ASUS' suppliers and its reseller. It is the maximum for which ASUS, its suppliers, and your reseller are collectively responsible.

UNDER NO CIRCUMSTANCES IS ASUS LIABLE FOR ANY OF THE FOLLOWING: (1) THIRD-PARTY CLAIMS AGAINST YOU FOR DAMAGES; (2) LOSS OF, OR DAMAGE TO, YOUR RECORDS OR DATA; OR (3) SPECIAL, INCIDENTAL, OR INDIRECT DAMAGES OR FOR ANY ECONOMIC CONSEQUENTIAL DAMAGES (INCLUDING LOST PROFITS OR SAVINGS), EVEN IF ASUS, ITS SUPPLIERS OR YOUR RESELLER IS INFORMED OF THEIR POSSIBILITY.

### RF Exposure Warning

The equipment complies with FCC RF exposure limits set forth for an uncontrolled environment. The equipment must not be co-located or operating in conjunction with any other antenna or transmitter.

### Radio Frequency (RF) Exposure Information

The radiated output power of the Wireless Device is below the Innovation, Science and Economic Development Canada (ISED) radio frequency exposure limits. The Wireless Device should be used in such a manner such that the potential for human contact during normal operation is minimized. This device has also been evaluated and shown compliant with the ISED RF Exposure limits under portable exposure conditions. (antennas are less than 20 cm of a person's body).

### Informations concernant l'exposition aux fréquences radio (RF)

La puissance de sortie rayonnée du dispositif sans fil est inférieure aux limites d'exposition aux radiofréquences d'Innovation, Sciences et Développement économique Canada (ISED). Le dispositif sans fil doit être utilisé de manière à minimiser le potentiel de contact humain pendant le fonctionnement normal. Cet appareil a également été évalué et montré conforme aux limites d'exposition RF ISED dans des conditions d'exposition portable. (les antennes mesurent moins de 20 cm du corps d'une personne).

### REACH

Complying with the REACH (Registration, Evaluation, Authorisation, and Restriction of Chemicals) regulatory framework, we published the chemical substances in our products at ASUS REACH website at <http://csr.asus.com/english/REACH.htm>.

### Compliance Statement of Innovation, Science and Economic Development Canada (ISED)

This device complies with Innovation, Science and Economic Development Canada licence exempt RSS standard(s). Operation is subject to the following two conditions: (1) this device may not cause interference, and (2) this device must accept any interference, including interference that may cause undesired operation of the device.

CAN ICES-003(B)/NMB-003(B)

### Déclaration de conformité de Innovation, Sciences et Développement économique Canada (ISED)

Le présent appareil est conforme aux CNR d'Innovation, Sciences et Développement économique Canada applicables aux appareils radio exempts de licence. L'exploitation est autorisée aux deux conditions suivantes : (1) l'appareil ne doit pas produire de brouillage, et (2) l'utilisateur de l'appareil doit accepter tout brouillage radioélectrique subi, même si le brouillage est susceptible d'en compromettre le fonctionnement.

CAN ICES-003(B)/NMB-003(B)

电子电气产品有害物质限制使用标识：图中之数字为产品之环保使用期限。仅指电子电气产品中含有的有害物质不致发生外泄或突变，从而对环境造成污染或对人身、财产造成严重损害的期限。

| 部件名称        | 有害物质   |        |        |              |            |              |
|-------------|--------|--------|--------|--------------|------------|--------------|
|             | 铅 (Pb) | 汞 (Hg) | 镉 (Cd) | 六价铬 (Cr(VI)) | 多溴联苯 (PBB) | 多溴二苯醚 (PBDE) |
| 印刷电路板及其电子组件 | x      | ○      | ○      | ○            | ○          | ○            |
| 外壳          | ○      | ○      | ○      | ○            | ○          | ○            |
| 外部信号连接器及线材  | ○      | ○      | ○      | ○            | ○          | ○            |
| 其它          | x      | ○      | ○      | ○            | ○          | ○            |

本表格依据 SJ/T 11364 的规定编制。  
○：表示该有害物质在该部件所有均质材料中的含量均在 GB/T 26572 规定的限量要求以下。  
×：表示该有害物质至少在该部件的某一均质材料中的含量超出 GB/T 26572 规定的限量要求，然该部件仍符合欧盟指令 2011/65/EU 的规范。  
备注：此产品所标示之环保使用期限，系指在一般正常使用状况下。

限用物質及其化學符號：

| 單元         | 限用物質及其化學符號 |        |        |                         |            |              |
|------------|------------|--------|--------|-------------------------|------------|--------------|
|            | 鉛 (Pb)     | 汞 (Hg) | 鎘 (Cd) | 六價鉻 (Cr <sup>VI</sup> ) | 多溴聯苯 (PBB) | 多溴二苯醚 (PBDE) |
| 印刷電路板及電子組件 | -          | ○      | ○      | ○                       | ○          | ○            |
| 外觀         | ○          | ○      | ○      | ○                       | ○          | ○            |
| 滾輪裝置       | -          | ○      | ○      | ○                       | ○          | ○            |
| 其他及其配件     | -          | ○      | ○      | ○                       | ○          | ○            |

備考 1. "○" 係指該項限用物質之百分比含量未超出百分比含量基準值。  
備考 2. "-" 係指該項限用物質為排除項目。

### NCC: Taiwan Wireless Statement

低功率射頻器材技術規範

取得審驗證明之低功率射頻器材，非經核准，公司、商號或使用者均不得擅自變更頻率、加大功率或變更原設計之特性及功能。低功率射頻器材之使用不得影響飛航安全及干擾合法通信；經發現有干擾現象時，應立即停用，並改善至無干擾時方得繼續使用。前述合法通信，指依電信管理法規作業之無線電通信。低功率射頻器材須忍受合法通信或工業、科學及醫療用電波輻射性電機設備之干擾。應避免影響附近雷達系統之操作。

### VCCI: Japan Compliance Statement

#### VCCI Class B Statement

VCCI 準拠クラス B 機器 (日本)

この装置は、クラス B 情報技術装置です。この装置は、家庭環境で使用することを目的としていますが、この装置がラジオやテレビジョン受信機に近接して使用されると、受信障害を引き起こすことがあります。取扱説明書に従って正しい取り扱いをして下さい。

### KC: Korea Warning Statement



### ASUS Recycling/Takeback Services

ASUS recycling and takeback programs come from our commitment to the highest standards for protecting our environment. We believe in providing solutions for you to be able to responsibly recycle our products, batteries, other components as well as the packaging materials. Please go to <http://csr.asus.com/english/Takeback.htm> for detailed recycling information in different regions.

### Proper disposal

DO NOT throw the device in municipal waste. This product has been designed to enable proper reuse of parts and recycling. The symbol of the crossed out wheeled bin indicates that the product (electrical, electronic equipment and mercury-containing button cell battery) should not be placed in municipal waste. Check local regulations for disposal of electronic products.

DO NOT throw the device in fire. DO NOT short circuit the contacts. DO NOT disassemble the device.

### UKCA RF Output table (The Radio Equipment Regulations 2017)

| Function  | Frequency       | Maximum Output Power (EIRP) |
|-----------|-----------------|-----------------------------|
| Bluetooth | 2402 - 2480 MHz | 10 dBm                      |

### CE RED RF Output table (Directive 2014/53/EU)

| Function  | Frequency       | Maximum Output Power (EIRP) |
|-----------|-----------------|-----------------------------|
| Bluetooth | 2402 - 2480 MHz | 10 dBm                      |

### Ukraine Certification Logo



### EAC Certification Logo



### Simplified UKCA Declaration of Conformity

ASUSTek Computer Inc. hereby declares that this device is in compliance with the essential requirements and other relevant provisions of The Radio Equipment Regulations 2017 (S.I. 2017/1206). Full text of UKCA declaration of conformity is available at <https://www.asus.com/support/>.

### CE Mark Warning

English ASUSTek Computer Inc. hereby declares that this device is in compliance with the essential requirements and other relevant provisions of related Directives. Full text of EU declaration of conformity is available at: [www.asus.com/support](http://www.asus.com/support)

Français AsusTek Computer Inc. déclare par la présente que cet appareil est conforme aux critères essentiels et autres clauses pertinentes des directives concernées. La déclaration de conformité de l'UE peut être téléchargée à partir du site Internet suivant : [www.asus.com/support](http://www.asus.com/support).

Deutsch ASUSTek Computer Inc. erklärt hiermit, dass dieses Gerät mit den wesentlichen Anforderungen und anderen relevanten Bestimmungen der zugehörigen Richtlinien übereinstimmt. Der gesamte Text der EU-Konformitätserklärung ist verfügbar unter: [www.asus.com/support](http://www.asus.com/support)

Italiano ASUSTek Computer Inc. con la presente dichiara che questo dispositivo è conforme ai requisiti essenziali e alle altre disposizioni pertinenti con le direttive correlate. Il testo completo della dichiarazione di conformità UE è disponibile all'indirizzo: [www.asus.com/support](http://www.asus.com/support)



Русский Компания ASUS заявляет, что это устройство соответствует основным требованиям и другим соответствующим условиям соответствующих директив. Подробную информацию, пожалуйста, смотрите на [www.asus.com/support](http://www.asus.com/support)

Български С настоящото ASUSTeK Computer Inc. декларира, че това устройство е в съответствие със съществените изисквания и другите приложими постановления на свързаните директиви. Пълният текст на декларацията за съответствие на ЕС е достъпна на адрес: [www.asus.com/support](http://www.asus.com/support)

Hrvatski ASUSTeK Computer Inc. ovim izjavljuje da je ovaj uređaj sukladan s bitnim zahtjevima i ostalim odgovarajućim odredbama vezanih direktiva. Cijeli tekst EU izjave o sukladnosti dostupan je na: [www.asus.com/support](http://www.asus.com/support)

Čeština Společnost ASUSTeK Computer Inc. tímto prohlašuje, že toto zařízení splňuje základní požadavky a další příslušná ustanovení souvisejících směrnic. Plné znění prohlášení o shodě EU je k dispozici na adrese: [www.asus.com/support](http://www.asus.com/support)

Dansk ASUSTeK Computer Inc. erklærer hermed, at denne enhed er i overensstemmelse med hovedkravene og andre relevante bestemmelser i de relaterede direktiver. Hele EU-overensstemmelseserklæringen kan findes på: [www.asus.com/support](http://www.asus.com/support)

Nederlands ASUSTeK Computer Inc. verklaart hierbij dat dit apparaat voldoet aan de essentiële vereisten en andere relevante bepalingen van de verwante richtlijnen. De volledige tekst van de EU-verklaring van conformiteit is beschikbaar op: [www.asus.com/support](http://www.asus.com/support)

Eesti Käesolevaga kinnitab ASUSTeK Computer Inc. et see seade vastab asjakohaste direktiivide olulistele nõuetele ja teisteles asjassepuutuvatele sätetele. EL vastavusdeklaratsiooni täielik tekst on saadaval järgmisel aadressil: [www.asus.com/support](http://www.asus.com/support)

Suomi ASUSTeK Computer Inc. ilmoittaa täten, että tämä laite on asiaankuuluvien direktiivien olennaisten vaatimusten ja muiden tätä koskevien säädösten mukainen. EU-yhdennmukaisuusilmoituksen koko teksti on luettavissa osoitteessa: [www.asus.com/support](http://www.asus.com/support)

Ελληνικά Με το παρόν, η AsusTek Computer Inc. δηλώνει ότι αυτή η συσκευή συμμορφώνεται με τις θεμελιώδεις απαιτήσεις και άλλες σχετικές διατάξεις των Οδηγιών της ΕΕ. Το πλήρες κείμενο της δήλωσης συμπατότητας είναι διαθέσιμο στη διεύθυνση: [www.asus.com/support](http://www.asus.com/support)

Magyar Az ASUSTeK Computer Inc. ezennel kijelenti, hogy ez az eszköz megfelel a kapcsolódó irányelvek lényeges követelményeinek és egyéb vonatkozó rendelkezéseinek. Az EU megfeleléségi nyilatkozat teljes szövege innen letölthető: [www.asus.com/support](http://www.asus.com/support)

Latviski ASUSTeK Computer Inc. ar šo paziņo, ka šī ierīce atbilst saistīto Direktīvu būtiskajām prasībām un citiem citiem saistošajiem nosacījumiem. Pilns ES atbilstības paziņojuma teksts pieejams šeit: [www.asus.com/support](http://www.asus.com/support)

Lietuvių „ASUSTeK Computer Inc.“ šiuo tvirtina, kad šis įrenginys atitinka pagrindinius reikalavimus ir kitas svarbias susijusių direktyvų nuostatas. Visą ES atitikties deklaracijos tekstą galima rasti: [www.asus.com/support](http://www.asus.com/support)

Norsk ASUSTeK Computer Inc. erklærer herved at denne enheten er i samsvar med hovedsaklige krav og andre relevante forskrifter i relateret direktiver. Fullstendig tekst for EU-samsvarserklæringen finnes på: [www.asus.com/support](http://www.asus.com/support)

Polski Firma ASUSTeK Computer Inc. niniejszym oświadczca, że urządzenie to jest zgodne z zasadniczymi wymogami i innymi właściwymi postanowieniami powiązanych dyrektyw. Pełny tekst deklaracji zgodności UE jest dostępny pod adresem: [www.asus.com/support](http://www.asus.com/support)

Português A ASUSTeK Computer Inc. declara que este dispositivo está em conformidade com os requisitos essenciais e outras disposições relevantes das Diretivas relacionadas. Texto integral da declaração da UE disponível em: [www.asus.com/support](http://www.asus.com/support)

Română ASUSTeK Computer Inc. declară că acest dispozitiv se conformează cerințelor esențiale și altor prevederi relevante ale directivelor conexe. Textul complet al declarației de conformitate a Uniunii Europene se găsește la: [www.asus.com/support](http://www.asus.com/support)

Srpski ASUSTeK Computer Inc. ovim izjavljuje da je ovaj uređaj u saglasnosti sa osnovnim zahtjevima i drugim relevantnim odredbama povezanih Direktiva. Pun tekst EU deklaracije o usaglašenosti je dostupan da adresi: [www.asus.com/support](http://www.asus.com/support)

Slovensky Spoločnosť ASUSTeK Computer Inc. týmto vyhlasuje, že toto zariadenie vyhovuje základným požiadavkám a ostatým príslušným ustanoveniam príslušných smerníc. Celý text vyhlásenia o zhode pre štáty EÚ je dostupný na adrese: [www.asus.com/support](http://www.asus.com/support)

Slovenščina ASUSTeK Computer Inc. izjavlja, da je ta naprava skladna z bistvenimi zahtevami in drugimi ustreznimi določbami povezanih direktiv. Celotno besedilo EU-izjave o skladnosti je na voljo na spletnem mestu: [www.asus.com/support](http://www.asus.com/support)

Español Por la presente, ASUSTeK Computer Inc. declara que este dispositivo cumple los requisitos básicos y otras disposiciones pertinentes de las directivas relacionadas. El texto completo de la declaración de la UE de conformidad está disponible en: [www.asus.com/support](http://www.asus.com/support)

Svenska ASUSTeK Computer Inc. förklarar härmed att denna enhet överensstämmer med de grundläggande kraven och andra relevanta föreskrifter i relaterade direktiv. Fulltext av EU-försäkran om överensstämmelse finns på: [www.asus.com/support](http://www.asus.com/support)

Українська ASUSTeK Computer Inc. заявляє, що цей пристрій відповідає основним вимогам та іншим відповідним положенням відповідних Директив. Повний текст декларації відповідності стандартам ЄС доступний на: [www.asus.com/support](http://www.asus.com/support)

Türkçe AsusTek Computer Inc., bu aygıtın temel gereksinimleri ve ilişkin Yönergelerin diğer ilgili koşullarıyla uyumlu olduğunu beyan eder. AB uyumluluk bildiriminin tam metni şu adreste bulunabilir: [www.asus.com/support](http://www.asus.com/support)

Bosanski ASUSTeK Computer Inc. ovim izjavljuje da je ovaj uređaj uskladen sa bitnim zahtjevima i ostalim odgovarajućim odredbama vezanih direktiva. Cijeli tekst EU izjave o uskladenosti dostupan je na: [www.asus.com/support](http://www.asus.com/support)

## FCC COMPLIANCE INFORMATION

Per FCC Part 2 Section 2.1077

FC

**Responsible Party:** **Asus Computer International**

**Address:** **48720 Kato Rd., Fremont, CA 94538, USA**

**Phone/Fax No:** **(510)739-3777/(510)608-4555**

hereby declares that the product

**Product Name :** **ROG CETRA TRUE WIRELESS**

**Model Number :** **ROG CETRA TRUE WIRELESS**

**compliance statement:**

This device complies with part 15 of the FCC Rules. Operation is subject to the following two conditions: (1) This device may not cause harmful interference, and (2) this device must accept any interference received, including interference that may cause undesired operation.

Ver. 180125

## Service and Support

Visit our multi-language website at <https://www.asus.com/support>.



## Официальное представительство в России

### Горячая линия Службы технической поддержки в России:

Бесплатный федеральный номер для звонков по России: 8-800-100-2787

Номер для пользователей в Москве: +7(495)231-1999

Время работы: Пн-Пт, 09:00 - 21:00 (по московскому времени)

### Официальные сайты ASUS в России:

[www.asus.ru](http://www.asus.ru)

[www.asus.com/ru/support](http://www.asus.com/ru/support)

Данное устройство соответствует требованиям Технического регламента Таможенного Союза ТР ТС 020/2011 Электромагнитная совместимость технических средств утв. решением КТС от 09.12.2011г. №879

|  |   |
|--|---|
| <b>Manufacturer</b>                                | ASUSTek COMPUTER INC.   |
| <b>Address, City</b>                               | 1F, No. 15, Lide Rd., Beitou Dist., Taipei City 112, Taiwan                     |
| <b>Authorized Representative in Europe</b>         | ASUS COMPUTER GmbH  |
| <b>Address</b>                                     | Harkortstrasse 21-23, 40880 Ratingen  |
| <b>Country</b>                                     | Germany   |
| <b>Authorized Representative in United Kingdom</b> | ASUSTEK (UK) LIMITED  |
| <b>Address</b>                                     | 1st Floor, Sackville House, 143-149 Fenchurch Street, London, EC3M 6BL, England |
| <b>Country</b>                                     | United Kingdom  |